

# ACCESS 30A4

12" (30cm) subwoofer



- DFS® Cone
- Sealed or ported enclosure

## FREQUENCY RESPONSE/IMPEDANCE

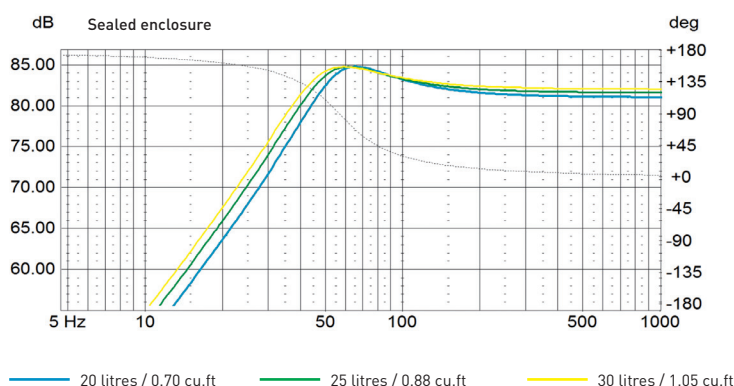

## MECHANICAL DRAWING

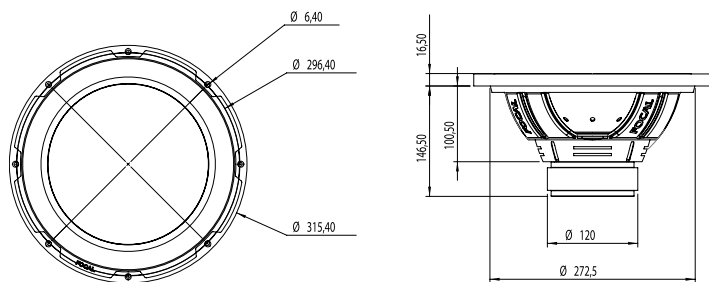

## SPECIFICATIONS

Nominal power	250W RMS	
Maximum power	500W	
Sensitivity (2,83V/1m)	87.18dB	
Cone	DFS® (Dual Fiberglass Structure)	
Surround	Butyl	
Nom. impedance	4 Ohms	
DC resistance	4 Ohms	
VC diameter	50mm	2"
VC height	25mm	1"
Former	Kapton	
Layers	4	
Wire	Copper	
Inductance	2,85mH	
Xmax	± 8,5mm	0 <sup>5</sup> / <sub>16</sub> "
Magnet d x h	120mm x 30mm	4 <sup>23</sup> / <sub>32</sub> " x 1 <sup>3</sup> / <sub>16</sub> "
Magnet weight	1250g	2.75 lbs
Flux density	0.8T	
Gap height	8mm	0 <sup>5</sup> / <sub>16</sub> "
Net weight	3.7kg	8.1 lbs

## PARAMETERS

Fs	24.7Hz
Vas	86.91 liters
Qts	0.671
Qes	0.764
Qms	5.49
Re	4.01 Ohms
Sd	510.71cm <sup>2</sup>
Cas	6.19E-07 m <sup>5</sup> /N
Mas	67.1kg/m <sup>4</sup>
Ras	1896.71 Ohms.ac
Cms	2.37E-04 m/N
Mms	175g
Rms	4.947Kg/s
Ces	1227.64mF
Les	33.82mH
Res	28.82 Ohms
BI	11.94N/A
SPL	84.18 dB/W/m

## SUGGESTED APPLICATION

Load	Volume	F-3 (Hz)
Sealed	20l-0.70cu.ft	38Hz
Sealed	25l-0.88cu-ft	35Hz
Sealed	30l-1.05cu-ft	32Hz

Load	Volume	Port Ø	Port lenght	F-3 (Hz)
Ported	25l-0.88cu.ft	9 cm-3 <sup>1</sup> / <sub>2</sub> "	35 cm-13 <sup>3</sup> / <sub>4</sub> "	38Hz
Ported	30l-1.05cu-ft	9 cm-3 <sup>1</sup> / <sub>2</sub> "	35 cm-13 <sup>3</sup> / <sub>4</sub> "	35Hz
Ported	35l-1.23cu-ft	9 cm-3 <sup>1</sup> / <sub>2</sub> "	35 cm-13 <sup>3</sup> / <sub>4</sub> "	34Hz

