

IS PSA 165

Technical Sheet

MADE IN
FRANCE

Woofer



- ABS chassis
- Polyglass cone, Butyl surround
- Neodymium magnet

FREQUENCY RESPONSE/IMPEDANCE

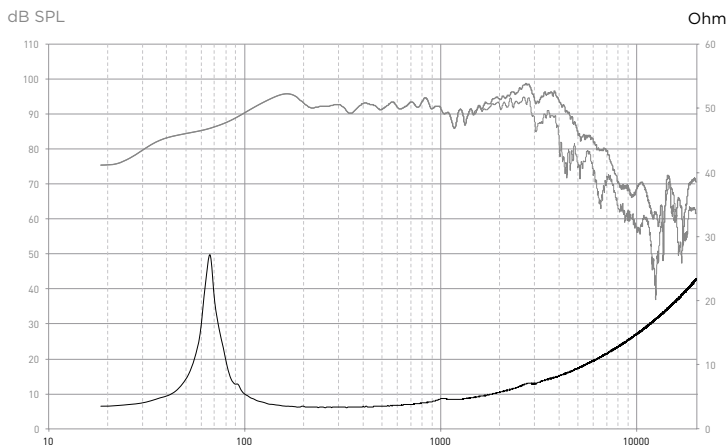

MECHANICAL DRAWING

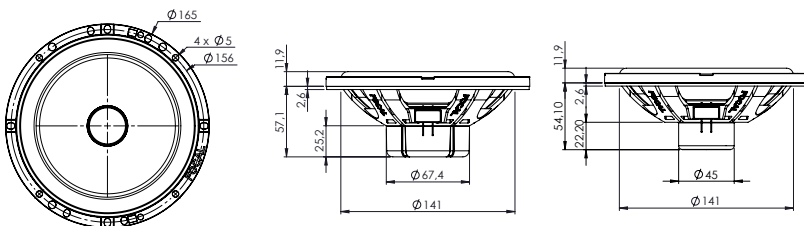

SPECIFICATIONS

| | | |
|------------------------|---------------|---------|
| Nominal power | 60W | |
| Maximum power | 120W | |
| Sensitivity (2,83V/1m) | 92.7 dB | |
| Cone | Polyglass | |
| Surround | Butyl | |
| Nom. impedance | 4 Ohms | |
| DC resistance | 2.7 Ohms | |
| VC diameter | 32mm | 1" |
| VC height | 10.5mm | 0.5/16" |
| Former | Kapton | |
| Layers | 2 | |
| Wire | Copper | |
| Inductance | 0.17mH | |
| Xmax | 2.75mm | 0.108" |
| Magnet d x h | 1.5mm x 5.5mm | - |
| Magnet weight | ??gr | 0.77 lb |
| Flux density | 1.T | |
| Gap height | 5mm | 0.3/16" |
| Net weight | 400g | 0.8 lb |

PARAMETERS

| | |
|-----|----------------------------|
| Fs | 69.24Hz |
| Vas | 10.65 l |
| Qts | 0.73 |
| Qes | 0.79 |
| Qms | 9.53 |
| Re | 2.89 Ohms |
| Sd | 132.73cm ² |
| Cas | 7.59 E-08m ⁵ /N |
| Mas | 69.65kg/m ⁴ |
| Ras | 3179 Ohms.ac |
| Cms | 431 μm/N |
| Mms | 12.27g |
| Rms | 0.56kg/s |
| Ces | 628.34mF |
| Les | 8.41mH |
| Res | 34.86 Ohms |
| Bl | 4.42N/A |
| SPL | 88.34 dB/W/m |

FOCAL[®] INSIDE

Focal[®] is a trademark of Focal-JMLab[®] - www.focal.com - SCAA190319/1

 **FOCAL**[®]
LISTEN BEYOND